

# Don't get shocked!

Electricity is very powerful and can cause serious injury or death.

## Dangers:

Electrical shock

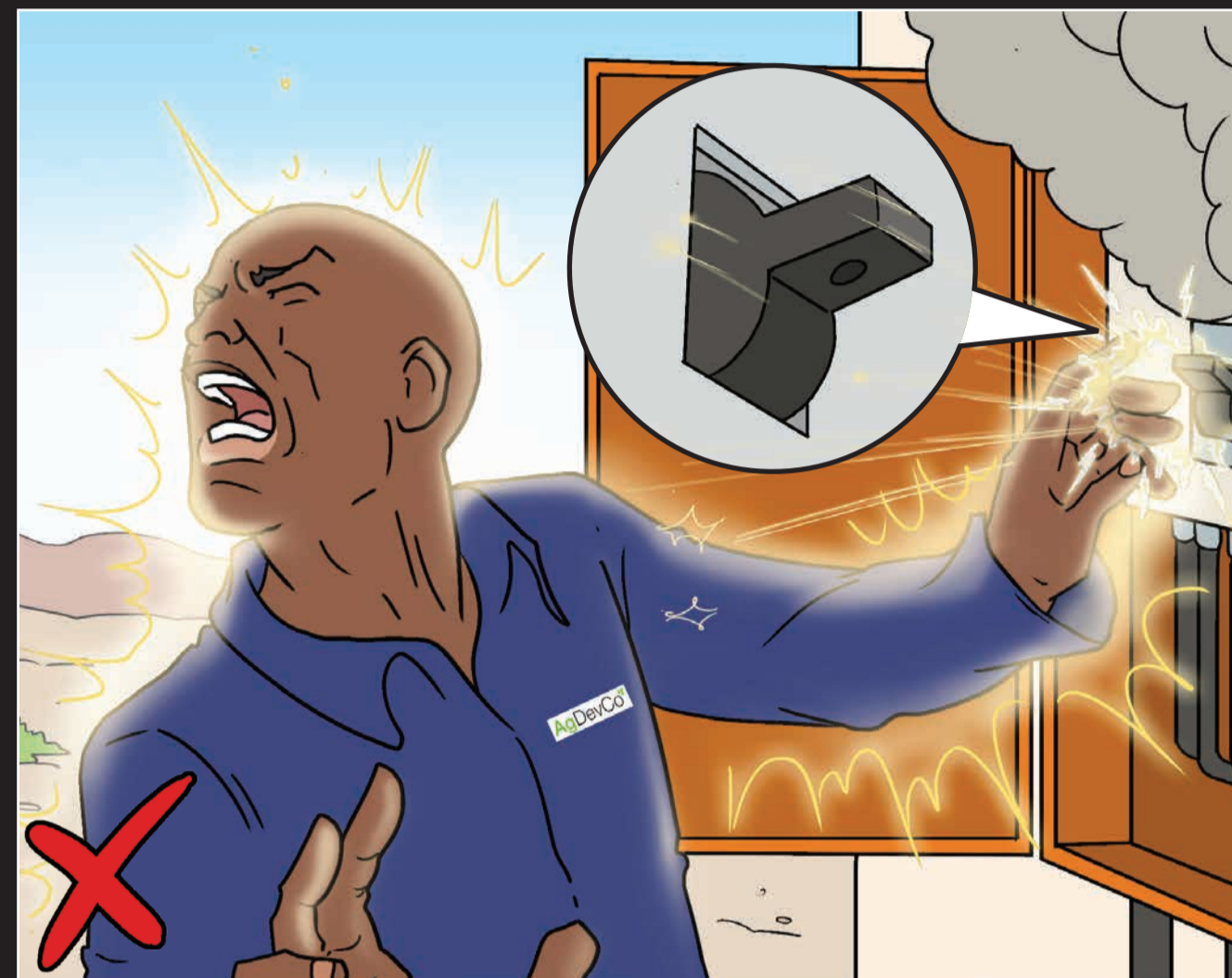

Electrical fire

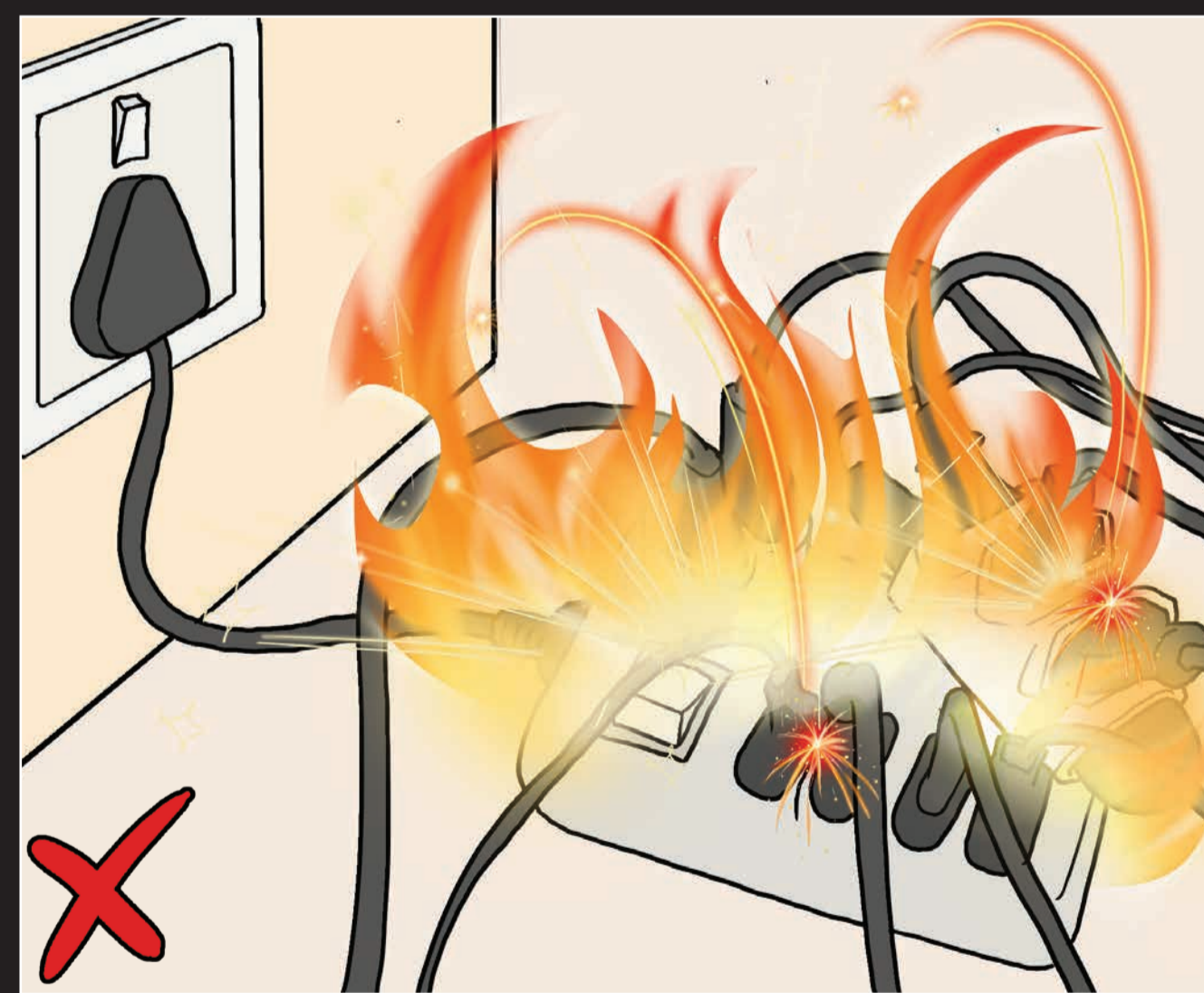

## Controls:

1. Always do a risk assessment.
2. Follow warning signs. Only authorised people must go into electrical danger areas.
3. Only trained employees with the right PPE and equipment must work with electrical equipment.



4. Always follow correct isolation procedures.
5. Don't use damaged equipment.

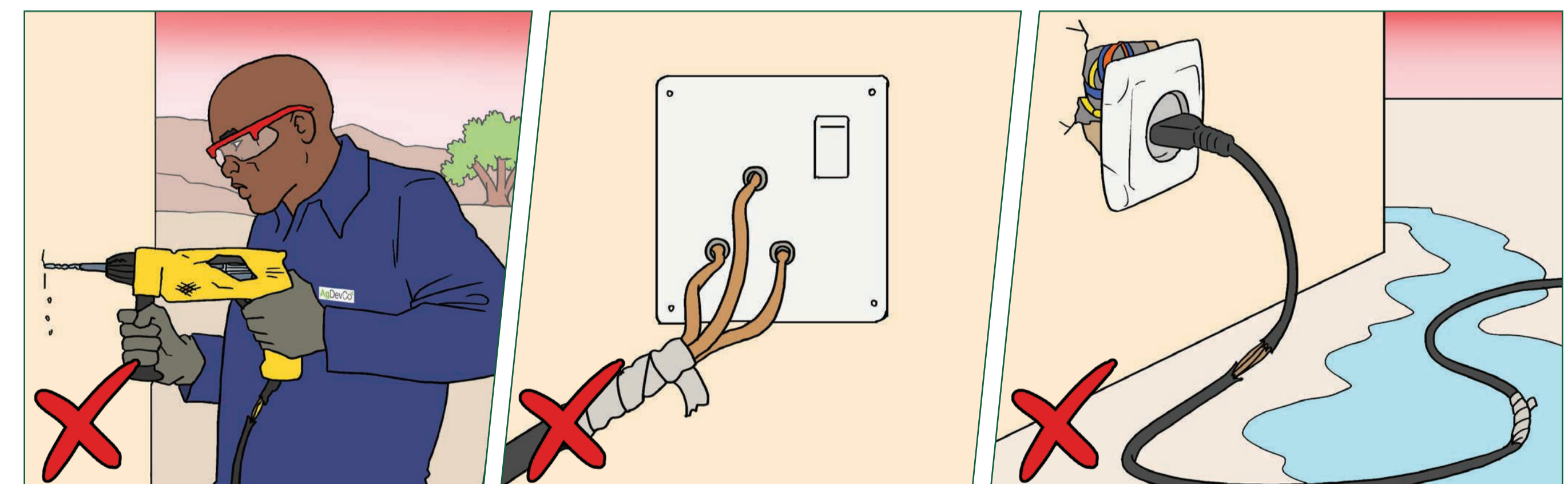

6. Maintenance of electrical equipment is very important.
7. Do electrical safety inspections.

